



CLIP top BLUMOTION CRISTALLO

Technical data sheet

www.blum.com

 **blum**[®]

CLIP top BLUMOTION CRISTALLO



Order specification



- Hinge for glass and mirror doors
- Adhesion plate is glued on to the front (no glass drilling necessary)
- Tool-free hinge to adhesion plate assembly
- **CLIP top BLUMOTION** with integrated **BLUMOTION** (and deactivation option)
- **CLIP top** with or without closing mechanism (spring)
- 110° opening angle
- 3-dimensional front adjustment
- Tool-free front to cabinet assembly and removal
- 0-protrusion: Position of front at opening angle 110°

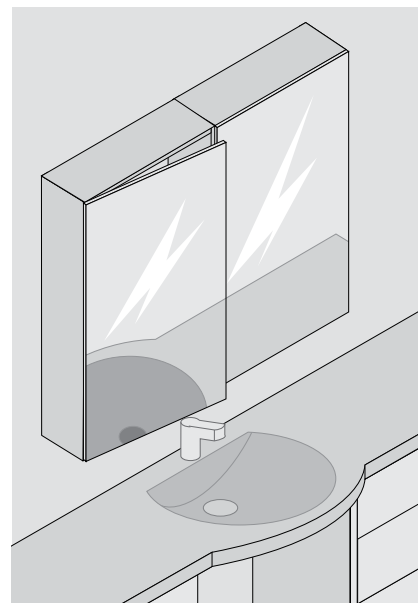

Overlay application, dual application, inset application

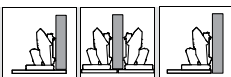

The different overlay applications can be achieved with the appropriate adhesion positions.

	Boss	<input type="checkbox"/>	CRISTALLO 110°	
	Hinge	Spring	Colour	Part no.
	CLIP top BLUMOTION	●	NI ONS	71B4500C
	CLIP top	●	NI	71T4500C
	CLIP top	○	NI	70T4500CTL
	● With spring ○ Unsprung		NI ONS Nickel plated Onyx black	

Disclaimer of liability

If the Blum fittings are installed according to instructions and on suitable glass and mirror fronts, they will meet the requirements concerning the stability of the connection.

This is monitored through internal and external testing.

As the adhesive and/or the adhesive process are beyond our control, Blum cannot accept liability for claims arising from the failure or malfunction of this/these process/es.

It is recommended that the adhesive be applied by an experienced glass manufacturer.

	<input type="checkbox"/>	CRISTALLO adhesion plate	
		Glue-on	
Front material	Colour		Part no.
Glass/mirror	Matt-nickel plated		70T4568C
Mirror	Special nickel plated		70T4568C

Accessories

	<input type="checkbox"/>	Hinge arm cover cap	
Print/Stamp	Logo	Colour	Part no.
Plain	–	NI ONS	70.4503
Stamped	Blum	NI	70.4503.BP

	<input type="checkbox"/>	Opening angle stop	
Opening angle	Colour		Part no.
85°	Dark grey		70T4503
92°	R7037 dust grey		70T4503.09

CLIP top BLUMOTION CRISTALLO



Planning

Hinge dimensions and gap calculation based on factory setting (mounting plate spacing = 0 mm)

Front protrusion at 90° opening angle

Overlay application		Dual application		Inset application	
A Cabinet front edge to centre of mounting plate drilling		A Cabinet front edge to centre of mounting plate drilling		A Cabinet front edge to centre of mounting plate drilling	
20 mm with mounting plate A20		20 mm with mounting plate A20		21.5 mm + front thickn. FD with mounting plate A20	
37 mm with mounting plate A37		37 mm with mounting plate A37		38.5 mm + front thickn. FD with mounting plate A37	
FA Front overlay		FA Front overlay			

Front Overlay in mm (FA) in relation to Distance K

MD	Front Overlay in mm (FA)																	
	-3.5	-3	-2.5	-2	-1.5	-1	2.5	4	5.5	7	8.5	10	11.5	13	14.5	16	17.5	19
0	0	0.5	1	1.5	2	2.5	6	7.5	9	10.5	12	13.5	15	16.5	18	19.5	21	22.5
3	3	3.5	4	4.5	5	5.5	9	10.5	12	13.5	15	16.5	18	19.5	21	22.5		
6	6	6.5	7	7.5	8	8.5	12	13.5	15	16.5	18	19.5	21	22.5				
9	9	9.5	10	10.5	11	11.5	15	16.5	18	19.5	21	22.5						
MD	Mounting plate spacing (mm)																	

Due to the risk of breakage to glass and mirror doors, sufficient gaps are required on all four edges (recommendation: min. 2 mm).

Distance K		Adjustment	
FA Front overlay		max. ±3.0 mm	
K Distance K		See mounting plates	
K = FA + 3.5 mm		±2.0 mm	
		+3.0 mm	
		-2.0 mm	

Note

Please contact your glass or front supplier concerning the selection and use of the adhesive in attaching the mounting/adhesive plate to glass and mirrors.

Assembly			Removal		

CLIP top BLUMOTION CRISTALLO



Order specification Glass display cabinets



- Hinge for glass display cabinets
- Mounting/adhesion plate is glued on (no glass drilling necessary)
- CLIP top BLUMOTION with integrated BLUMOTION (and deactivation option)
- CLIP top with or without closing mechanism (spring)
- 110° opening angle
- 3-dimensional front adjustment
- Tool-free front to cabinet assembly and removal

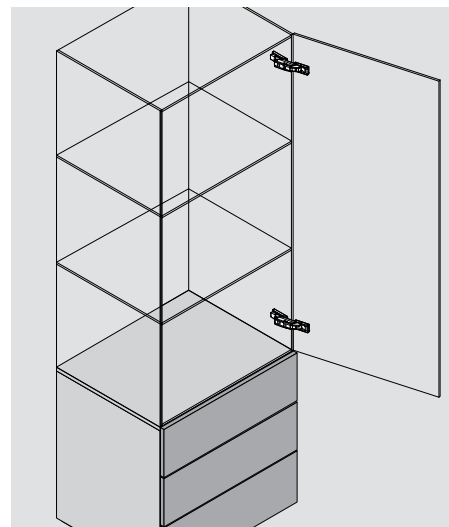

Inset application

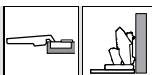

Boss		<input type="checkbox"/>	CRISTALLO 110°	
Hinge	Spring		Colour	Part no.
CLIP top BLUMOTION	●		NI ONS	71B4500C
CLIP top	●		NI	71T4500C
CLIP top	○		NI	70T4500CTL
●	With spring		NI	Nickel plated
○	Unsprung		ONS	Onyx black

CRISTALLO adhesion plate		<input type="checkbox"/>
Glue-on		
Front material	Colour	Part no.
Glass/mirror	Matt-nickel plated	70T4568C
Mirror	Special nickel plated	70T4568C

CRISTALLO mounting plate		<input type="checkbox"/>
Glue-on		
Front material	Colour	Part no.
Glass/mirror	Matt-nickel plated	175M4C20N

Accessories

Accessories			
	<input type="checkbox"/>	Hinge arm cover cap	
Print/Stamp	Logo	Colour	Part no.
Plain	–	NI ONS	70.4503
Stamped	Blum	NI	70.4503.BP

Opening angle stop		<input type="checkbox"/>
Opening angle	Colour	Part no.
85°	Dark grey	70T4503
92°	R7037 dust grey	70T4503.09

Disclaimer of liability

If the Blum fittings are installed according to instructions and on suitable glass and mirror fronts, they will meet the requirements concerning the stability of the connection.

This is monitored through internal and external testing.

As the adhesive and/or the adhesive process are beyond our control, Blum cannot accept liability for claims arising from the failure or malfunction of this/these process/es.

It is recommended that the adhesive be applied by an experienced glass manufacturer.

CLIP top BLUMOTION CRISTALLO



Planning Glass display cabinets

Hinge dimensions and gap calculation based on factory setting (mounting plate spacing = 0 mm)

Inset application

FD	Front thickness
F	Gap
KM	Mounting plate distance
KT	Adhesion plate distance

Adhesion plate distance

F	Gap
KT	Adhesion plate distance
KT = 5.5 mm – F	

Mounting plate distance

FD	Front thickness
KM	Mounting plate distance
KM = FD + 4.5 mm	

Adjustment

Max. ±2.0 mm	±2.0 mm	+3.0 mm –2.0 mm
--------------	---------	--------------------

Note

Please contact your glass or front supplier concerning the selection and use of the adhesive in attaching the mounting/adhesive plate to glass and mirrors.

Assembly

Removal

CLIP top BLUMOTION CRISTALLO



Order specification Bathroom mirror cabinets with fronts that protrude all the way around



- Mounting plate is glued on to the front
- Boss hole on the cabinet
- CLIP top BLUMOTION with integrated BLUMOTION (and deactivation option)
- CLIP top without closing mechanism (spring)
- Opening angle 95°
- 3-dimensional front adjustment
- Tool-free front to cabinet assembly and removal
- With INSERTA tool-free hinge to door assembly

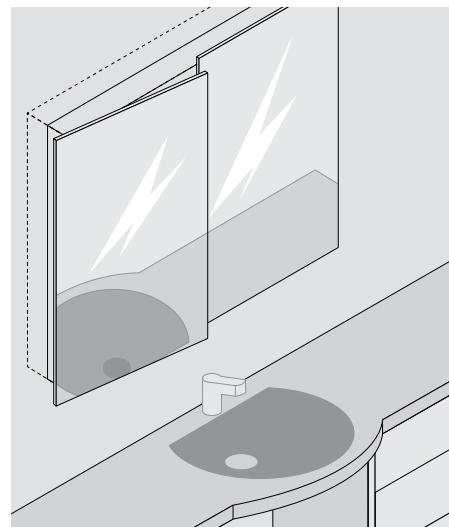

Hinge with double cranked hinge arm



Boss		INSERTA	
Hinge	Spring	Colour	Part no.
CLIP top BLUMOTION	●	NI	71B9790
○ With spring Unsprung		NI Nickel plated	

Boss		Screw-on	
Hinge	Spring	Colour	Part no.
CLIP top BLUMOTION	●	NI	71B9750
CLIP top	○	NI	70T9750.TL

CRISTALLO mounting plate		
Glue-on		
Front material	Colour	Part no.
Glass/mirror	Matt-nickel plated	175M4C20N

Accessories



Chipboard screw

Ø (mm)	Length (mm)	Part no.
3.5	15	609.1500
3.5	17	609.1700

Disclaimer of liability

If the Blum fittings are installed according to instructions and on suitable glass and mirror fronts, they will meet the requirements concerning the stability of the connection.

This is monitored through internal and external testing.

As the adhesive and/or the adhesive process are beyond our control, Blum cannot accept liability for claims arising from the failure or malfunction of this/these process/es.

It is recommended that the adhesive be applied by an experienced glass manufacturer.

Accessories



Hinge arm cover cap

Print/Stamp	Logo	Colour	Part no.
Plain	—	NI ONS	70.1663
Stamped	Blum	NI	70.1663.BP



Hinge boss cover cap

Hinge	Part no.
CLIP top BLUMOTION	70T3504
CLIP top	70T1504

Note

Only recommended for wall cabinets due to lower load bearing limits!

CLIP top BLUMOTION CRISTALLO



Planning Bathroom mirror cabinets with fronts that protrude all the way around

Hinge dimensions and gap calculation based on factory setting (mounting plate 175M4C20N)

Hinge with double cranked arm

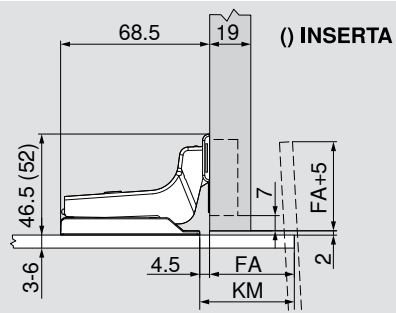

FA Front overlay

KM Mounting plate distance

Distance K

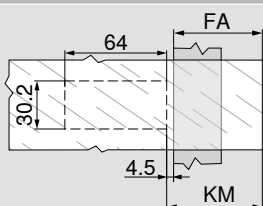

FA Front overlay

FA = max. 70 mm

KM Mounting plate distance

KM = FA + 4.5 mm

Adjustment

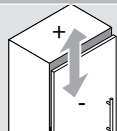

Max. ± 2.0 mm

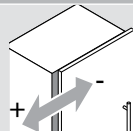

+2.0 mm
-3.0 mm

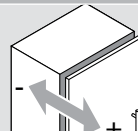

± 2.0 mm

Note

Please contact your glass or front supplier concerning the selection and use of the adhesive in attaching the mounting/adhesive plate to glass and mirrors.

Assembly

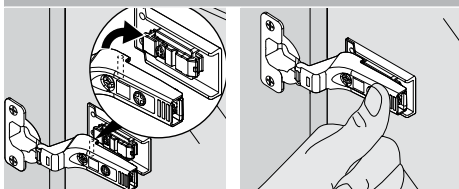

Removal

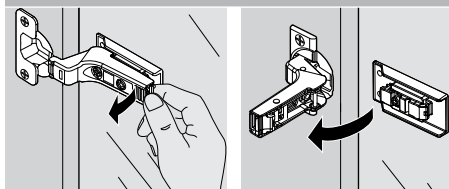

CLIP top BLUMOTION CRISTALLO



Order specification Angled application



- Hinge for glass and mirror doors
- Adhesion plate is glued on to the front (no glass drilling necessary)
- Tool-free hinge to adhesion plate assembly
- **CLIP top BLUMOTION** with integrated **BLUMOTION** (and deactivation option)
- **CLIP top** with or without closing mechanism (spring)
- 110° opening angle
- 3-dimensional front adjustment
- Tool-free front to cabinet assembly and removal

Page instructions					
WA	Angle	WA	Angle		
	-5°		5°	10°	15°
	Nº 106		Nº 103	Nº 104	Nº 105
	8		9	9	9
	Nº 107		Nº 100	Nº 101	Nº 102
	8		9	9	9
WA angled application					

	Boss		CRISTALLO 110°	
	Hinge	Spring	Colour	Part no.
	CLIP top BLUMOTION	●	NI	71B4500C
	CLIP top	●	NI	71T4500C
	CLIP top	○	NI	70T4500CTL
	● With spring ○ Unsprung		NI Nickel plated	

	CRISTALLO adhesion plate	
	Glue-on	
Front material	Colour	Part no.
Glass/mirror	Matt-nickel plated	70T4568C
Mirror	Special nickel plated	70T4568C

Accessories			
		Hinge arm cover cap	
Print/Stamp	Logo	Colour	Part no.
Plain	—	NI ONS	70.4503
Stamped	Blum	NI	70.4503.BP

Disclaimer of liability

If the Blum fittings are installed according to instructions and on suitable glass and mirror fronts, they will meet the requirements concerning the stability of the connection.

This is monitored through internal and external testing.

As the adhesive and/or the adhesive process are beyond our control, Blum cannot accept liability for claims arising from the failure or malfunction of this/these process/es.

It is recommended that the adhesive be applied by an experienced glass manufacturer.

Note

These dimensions are based on a factory setting of 19mm side panels. The overlay application changes in cases of variance. A trial application is recommended. The fixing position of the mounting plate can be different from the standard fixing position.

№ 106 -5°			№ 107 -5°			№ 103 5°					
Description	Spacing (mm)		Part no.	Description	Spacing (mm)		Part no.	Description	Spacing (mm)		Part no.
Mounting plate	0		173H7100	Mounting plate	0		173H7100	Mounting plate	0		173H7100
Angled spacer	-5°	1 x	171A5500	Angled spacer	-5°	1 x	171A5500	Angled spacer	+5°	1 x	171A5010

CLIP top BLUMOTION CRISTALLO



Planning

Angled application

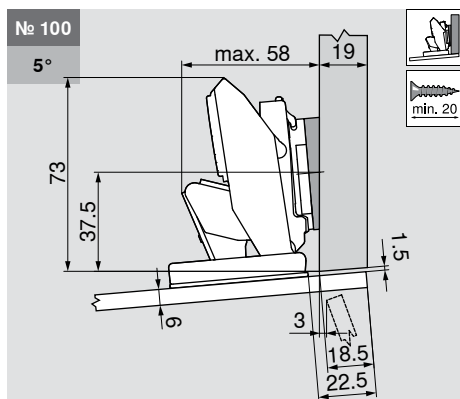

Description	Spacing (mm)	Part no.
Mounting plate	0	173H7100
Angled spacer	+5° 1 x	171A5010

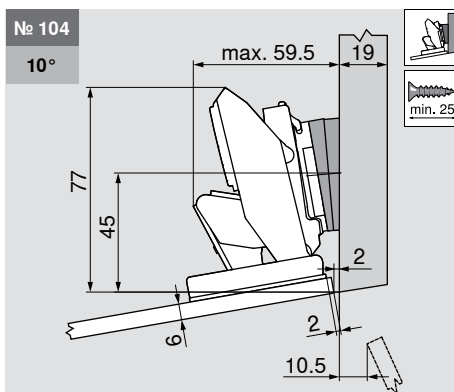

Description	Spacing (mm)	Part no.
Mounting plate	0	173H7100
Angled spacer	+5° 2 x	171A5010

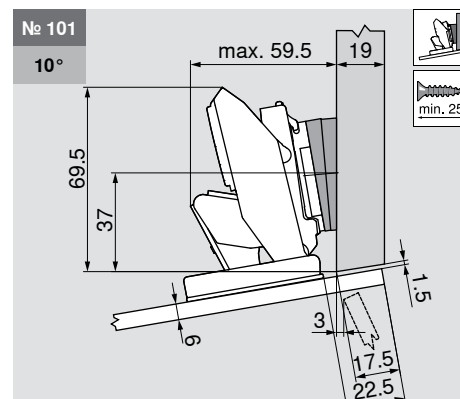

Description	Spacing (mm)	Part no.
Mounting plate	0	173H7100
Angled spacer	+5° 2 x	171A5010

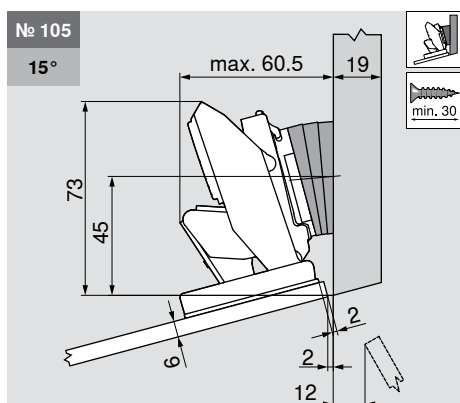

Description	Spacing (mm)	Part no.
Mounting plate	0	173H7100
Angled spacer	+5° 3 x	171A5010

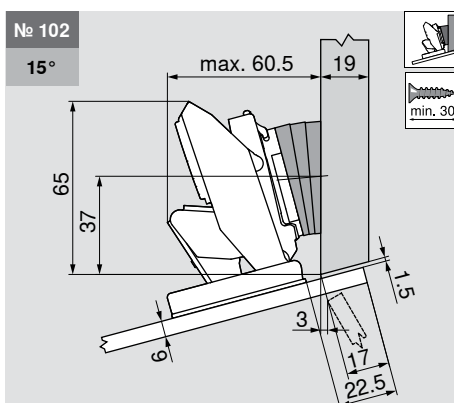

Description	Spacing (mm)	Part no.
Mounting plate	0	173H7100
Angled spacer	+5° 3 x	171A5010

Note

Please contact your glass or front supplier concerning the selection and use of the adhesive in attaching the mounting/adhesive plate to glass and mirrors.

Adjustment

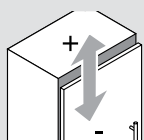

max. ± 3.0 mm

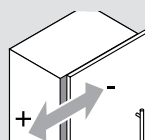

± 2.0 mm

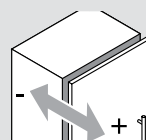

+3.0 mm

-2.0 mm

See mounting plates

Assembly

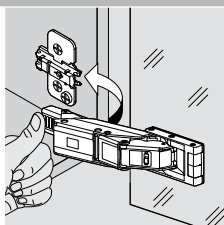
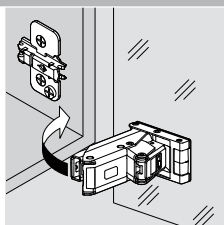
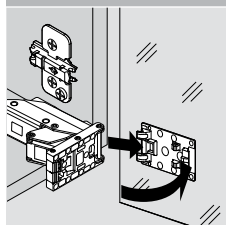

Removal

